





# LAVAN541

## INVENTORY, MEASUREMENTS + TECHNICAL SPECS

Item	Description	Image
<p><b>BLACK FOLDING CHAIR</b></p> <p><b>100 Available</b></p> <p>Any furniture that the Venue supplies will be given in "As Is" condition. Any damage incurred to the furniture during the event will be the responsibility of the Client and billed to the Client.</p>	<p>Width: 17.5"</p> <p>Depth: 18"</p> <p>Height: 30.75"</p> <p>Seating Depth: 13.75"</p> <p>Seating Height: 18.5"</p>	
<p><b>Black Armchair</b></p> <p><b>1 Available</b></p> <p>Any furniture that the Venue supplies will be given in "As Is" condition. Any damage incurred to the furniture during the event will be the responsibility of the Client and billed to the Client.</p>	<p>Depth: 18 "</p> <p>Width: 20 "</p> <p>Height: 34"</p>	



Item	Description	Image
<p><b>White Vanity</b></p> <p><b>1 Available</b></p> <p>Any furniture that the Venue supplies will be given in "As Is" condition. Any damage incurred to the furniture during the event will be the responsibility of the Client and billed to the Client.</p>	<p>Length: 60"</p> <p>Depth: 30"</p> <p>Height: 42"</p>	
<p><b>Vanity Mirrors</b></p> <p><b>2 Available</b></p> <p>Any furniture that the Venue supplies will be given in "As Is" condition. Any damage incurred to the furniture during the event will be the responsibility of the Client and billed to the Client.</p>	<p>Length: 19.7"</p> <p>Depth: 2.4"</p> <p>Height: 25.6"</p>	
<p><b>White Vanity Stools</b></p> <p><b>2 Available</b></p> <p>Any furniture that the Venue supplies will be given in "As Is" condition. Any damage incurred to the furniture during the event will be the responsibility of the Client and billed to the Client.</p>	<p>Length: 15.5 "</p> <p>Width: 15.5"</p> <p>Height: 25.5-34 "</p>	

Item	Description	Image
<p>6 ft Table</p> <p>10 available</p>	<p>Length: 72"</p> <p>Width: 36"</p> <p>Height: 30"</p>	
<p>Double Door Refrigerator</p> <p>1 available</p>	<p>Width: 54"</p> <p>Depth: 32.2'</p> <p>Height: 82.5"</p>	
<p>Ice Machine</p>	<p>Ice is available for your event at no extra fee</p>	

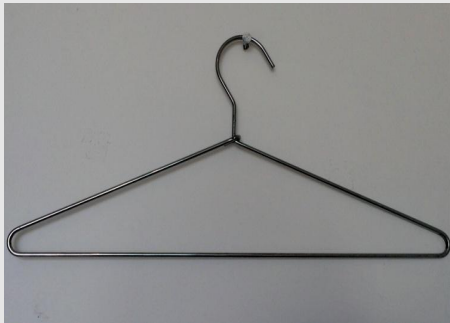

Item	Description	Image
<p>Warming Proofer Rack</p> <p>2 available</p>	<p>Length: 60"</p> <p>Depth: 30"</p> <p>Height: 42"</p>	
<p>Double Door Oven</p> <p>2 available</p>		

Item	Description	Image
<p>Coat Rack 8 available</p>		
<p>Hangers 350 available</p>		

Item	Description	Image
<p>White Modular Sofa</p> <p>11 standard pieces</p> <p>2 corner pieces</p> <p>Any furniture that the Venue supplies will be given in “As Is” condition. Any damage incurred to the furniture during the event will be the responsibility of the Client and billed to the Client.</p>	<p>27.25" H x 28" W x 28.75" D</p>	

Item	Description	Image
<p><b>High Top Cocktail Table</b></p> <p><b>10 available</b></p> <p>Any furniture that the Venue supplies will be given in “As Is” condition. Any damage incurred to the furniture during the event will be the responsibility of the Client and billed to the Client.</p>	<p>Top: 22x22”</p> <p>Height: 42”</p>	
<p><b>Coffee Table</b></p> <p><b>12 available</b></p> <p>Any furniture that the Venue supplies will be given in “As Is” condition. Any damage incurred to the furniture during the event will be the responsibility of the Client and billed to the Client.</p>	<p>Top: 18x18”</p> <p>Height: 16”</p>	

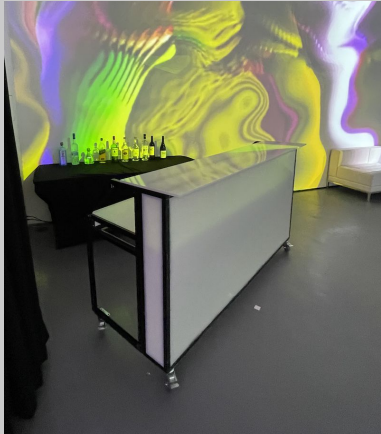

Item	Description	Image
Satellite Bar	Front Panel: H 36" x W 75"	
DJ Booth	H 42" x W 68" x D 19.5"	

# MEASUREMENTS - Pre Function Room

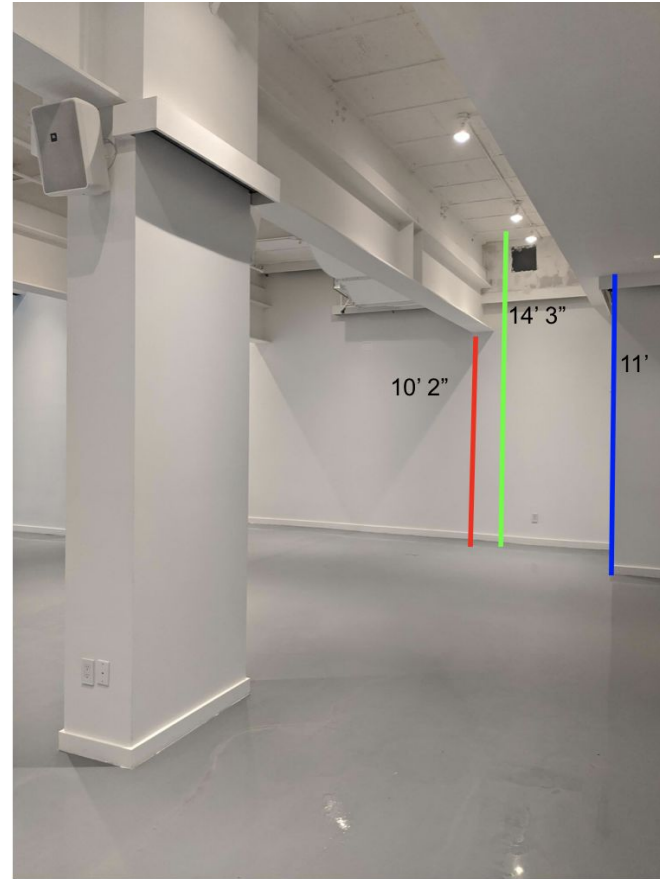
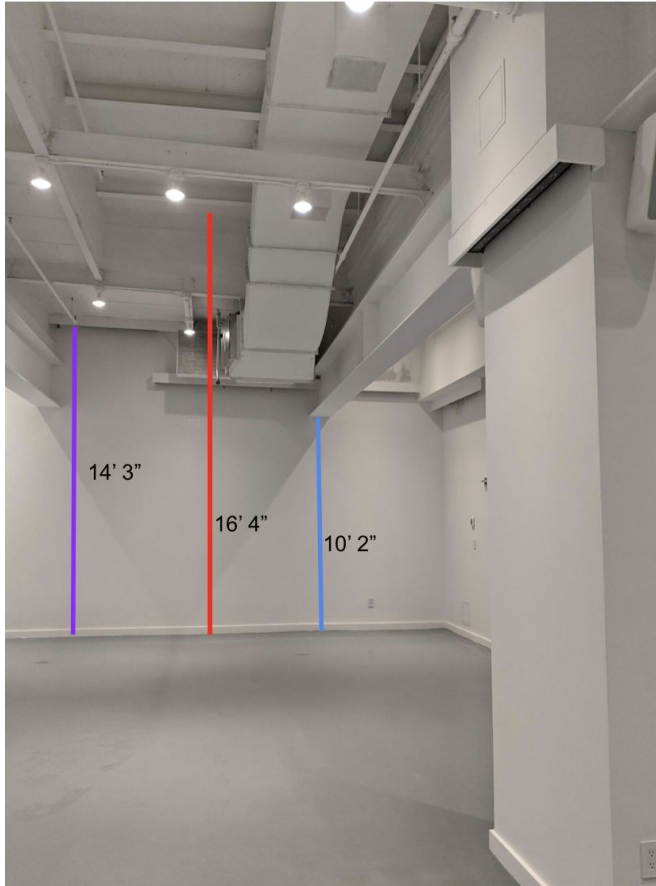

# MEASUREMENTS - Pre Function Room Windows +Vestibule

Street Facing Windows	From the view of standing inside	
window 1 (far left)	W 39" x H 27 3/4"	Top middle H 27 3/4" Top side H 23 3/4"
Window 2	W 40 3/4" x H 27 3/4"	Top middle H is 27 3/4" Top side H is 23 3/4"
Window 3 (window that opens)	W 43 3/4" x H 27 3/4"	Top middle H is 27 3/4" Top side H is 23 3/4"
Window 4 (far right)	W 43 3/4" x H 27 3/4"	Top middle H is 27 3/4" Top side H is 23 3/4"

Vestibule	
Non-door Glass side	W 112 3/4" x H 136 1/4"
Glass doors	W 35 1/2" x H 113 1/4"
wall to left of glass door (from inside)	W 25 1/4" x H 136 1/4"
Wall to right of glass door (from inside)	W 24 1/4" x H 136 1/4"
Wall above inside glass doors	W 71 1/2" x H 22 3/4"

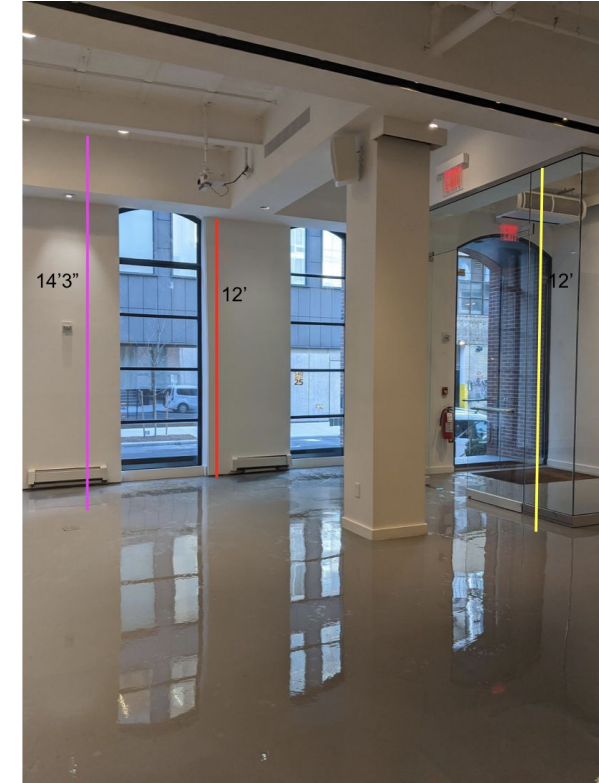

# MEASUREMENTS - Skylight Room

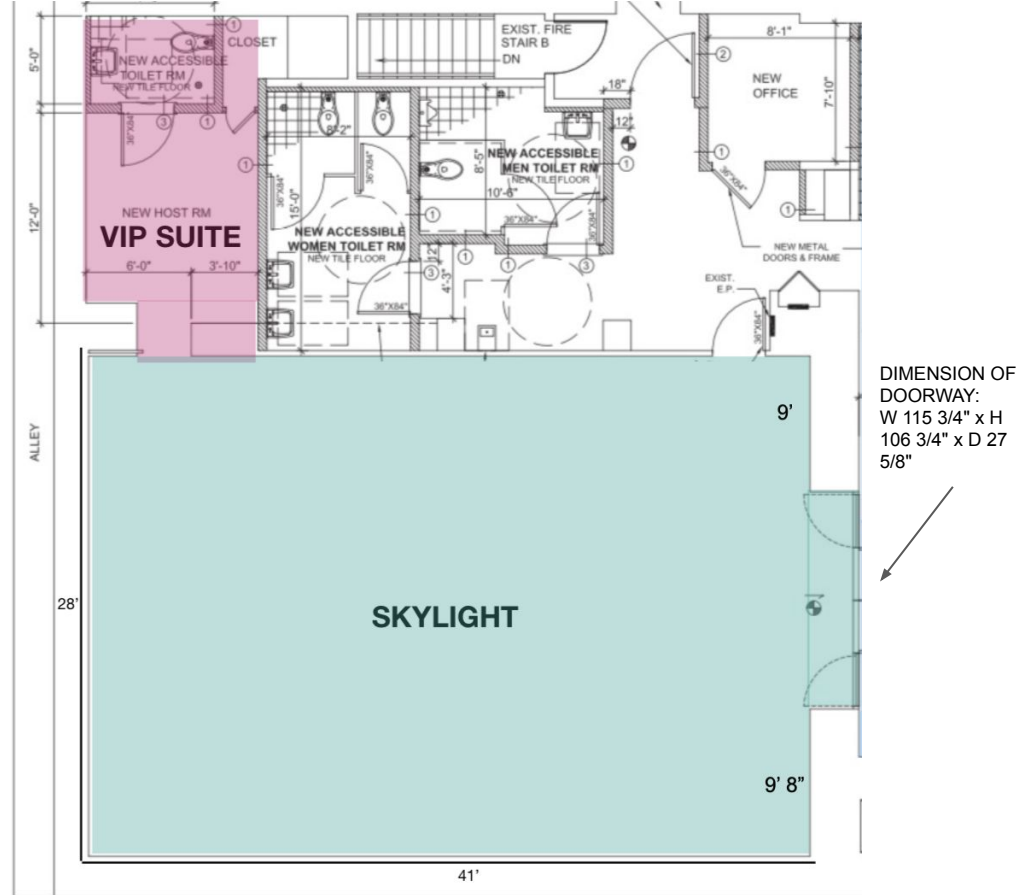

# MEASUREMENTS - FULL FLOOR PLAN

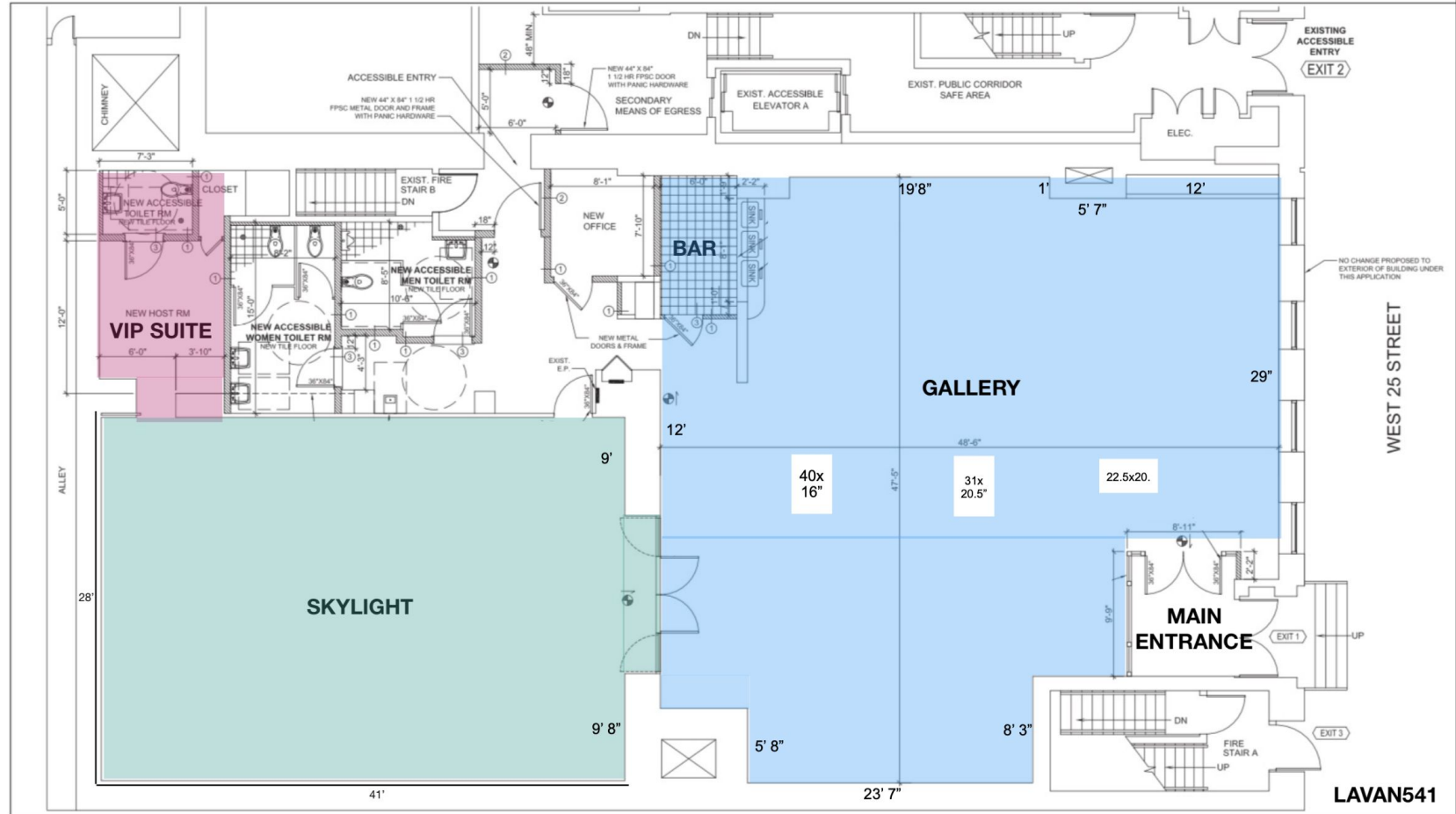

# TECHNICAL SPECS

## Wifi

Verizon Fios Gigabit Connection - Fios Gigabit Connection. Speeds up to 940/880 Mbps, 100% fiber-optic network.

## Power

100 amp 3 phase camlock box. Rhino-hide single pole cam-type connectors. A Leviton 15D21-U Male connector is needed.

## Audio

JBL Speakers

3 sound zones

Zone 1: Pre Function Space - 8 speakers.

Zone 2: Skylight Room - 6 speakers.

Zone 3: Bathrooms/Green Room - 4 speakers.

XLR inputs

## Lighting

LED Mood lighting system. RGBAW color scale

Controlled from IPad

Lighting Zones:

- Pre Function Space perimeter Walls
- Pre Function Space Windows
- Pre Function Space Columns
- Under Bar
- Back Bar Shelves
- Coat Check Room
- Restrooms (Both same zone)
- Skylight Room
- Glass Box
- Infinity Mirror



# PROJECTION



## Additional Information:

- 270° immersive projection
- (5) 20K Panasonic laser projectors
- Live X Mural custom media servers
- Multiple layers of content
- 7235(h)x1000(w) resolution "mural" surface
- Three scalable and positionable PIP windows
- Two additional HDMI inputs